

ROSTA Motorbases

Self-tensioning Motor Mounts for all Friction Belt Drives
slippage-free – belt protecting – maintenance-free

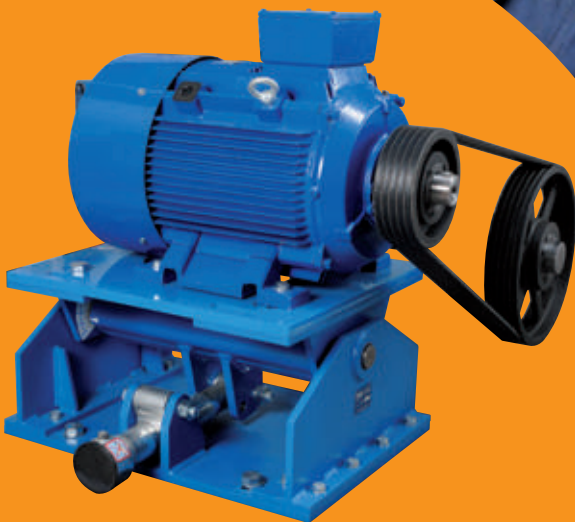

Customer Benefits of the ROSTA



MB 27

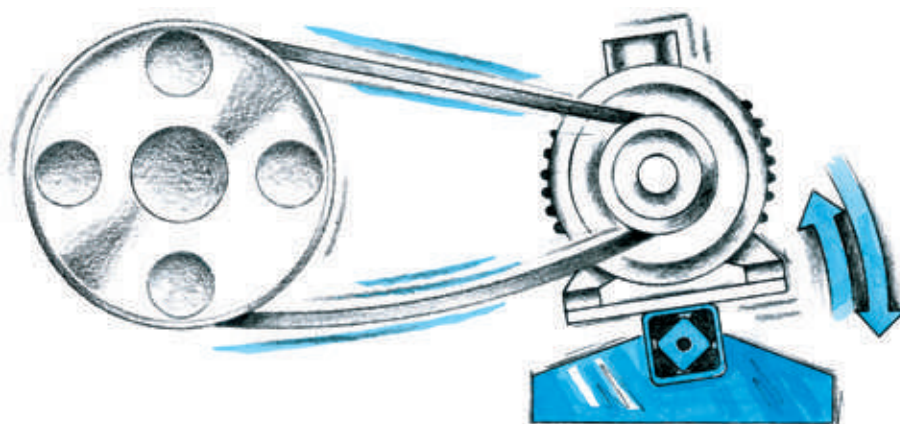

Offers short-term slippage by the start-up of large inertias, avoiding excessive tension on belt-carcass!

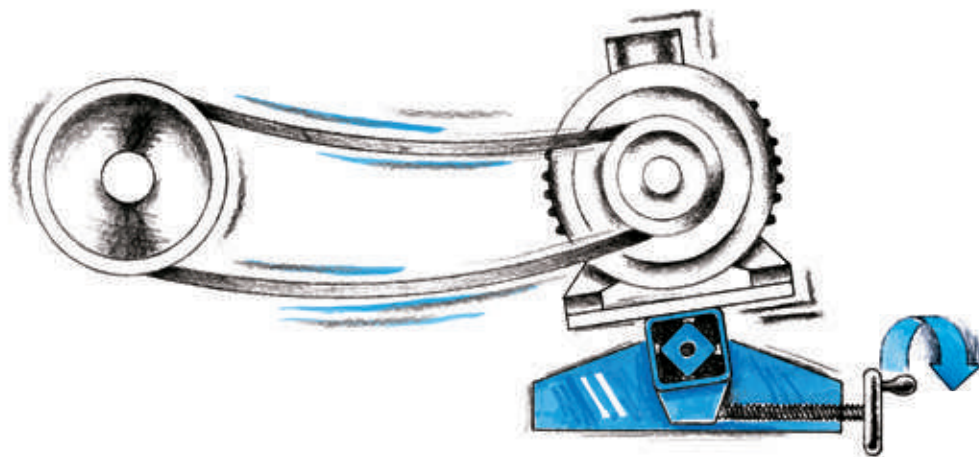

Offers fast belt changing, no need of complex readjustment of the pulleys!



MB 38

Fully maintenance-free tensioning system, no need of periodical compensation of belt elongation!

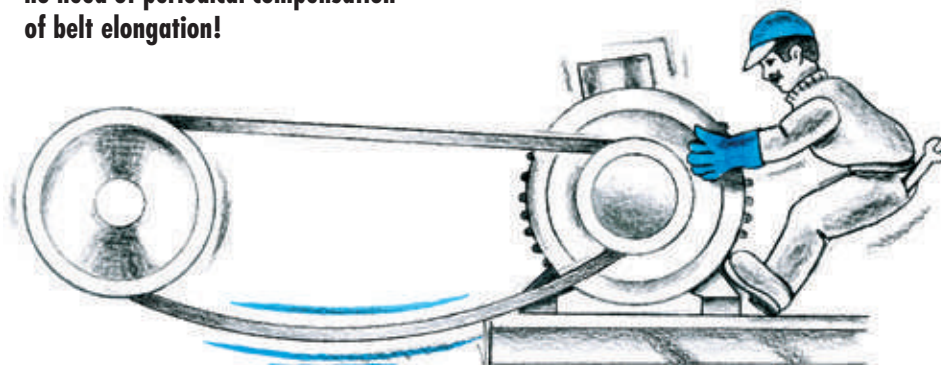

Motorbases in Friction Belt Drives

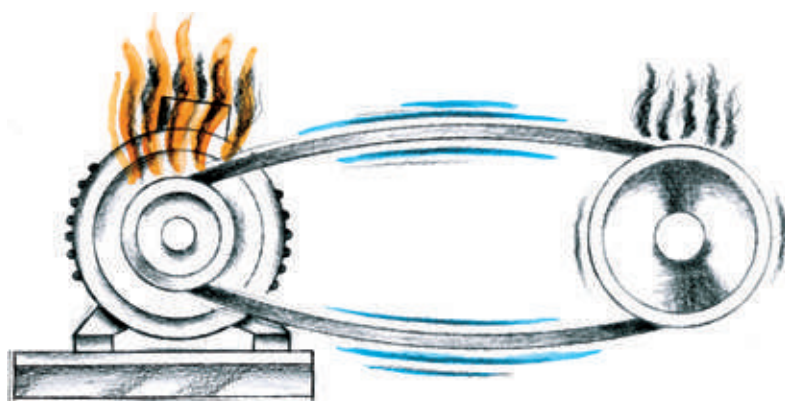

**Prevents from slack accruegment,
avoids heat generating slippage of the belts
and averts from premature belt failure!**

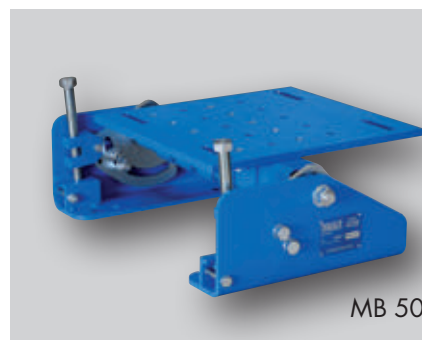

MB 50

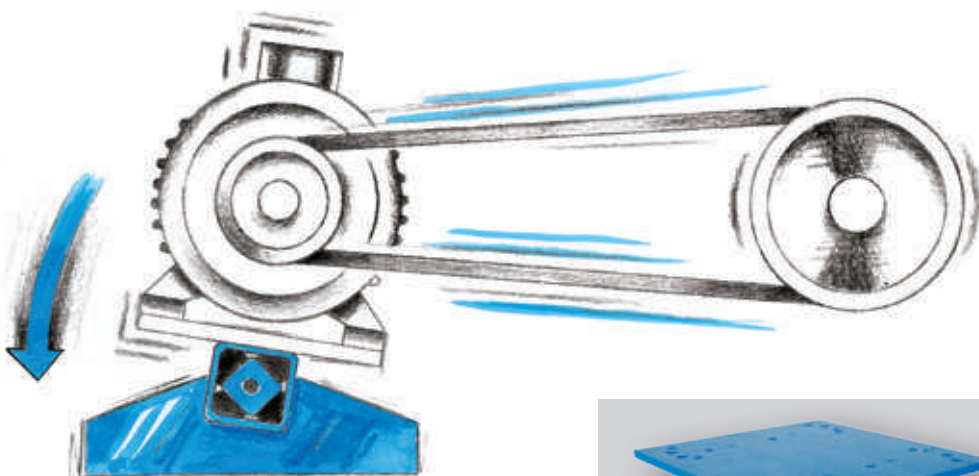

**Offers ideal belt tension,
constant transmission of nominal torque,
less energy consumption,
can lead to threefold belt lifetime!**

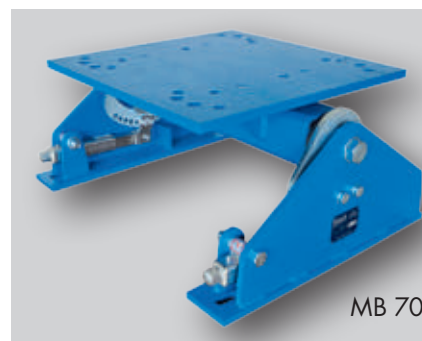

MB 70

**Noiseless power transmission,
all time ideally tightened belt sets!**

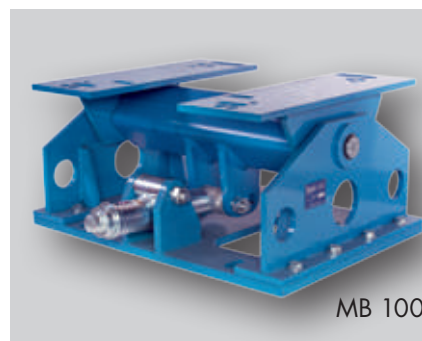
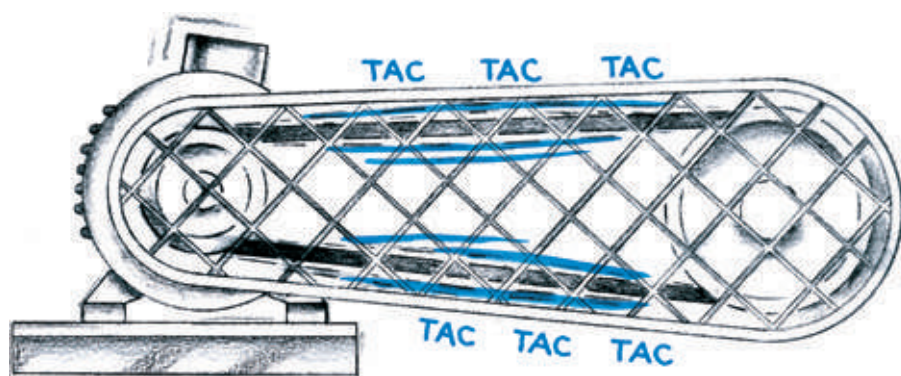

MB 100

Selection table of ROSTA Motorbases according to the motor frame sizes

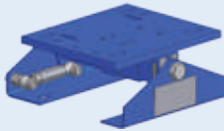
IEC			NEMA			Type of Motorbase	Details	Standard Design
Motor Frame Size	P [kW] 1000 min ⁻¹ 6-pole motor	P [kW] 1500 min ⁻¹ 4-pole motor	Motor Frame Size	P [HP] 1200 min ⁻¹ 6-pole motor	P [HP] 1800 min ⁻¹ 4-pole motor			
90S 90L	0.75 1.1	1.1 1.5	143T 145T	0.75 1	1 1.5 / 2	MB 27×120	Pages 5.6– 5.7	MB 27 
100L	1.5	2.2 / 3	182T	1.5	3			
112M	2.2	4	184T	2	5			
132S 132M	3 4 / 5.5	5.5 7.5	213T 215T	3 5	7.5 10	MB 38×300	Pages 5.6– 5.7	MB 38 
160M 160L	7.5 11	11 15	254T 256T	7.5 10	15 20			
160M 160L	7.5 11	11 15	254T 256T	7.5 10	15 20	MB 50×270-1	Pages 5.8– 5.9	MB 50 
180M 180L	– 15	18.5 22	284T 286T	15 20	25 30	MB 50×270-2		
200L	18.5 / 22	30	324T 326T	25 30	40 50	MB 50×400		
225S 225M	– 30	37 45	364T 365T	40 50	60 75	MB 50×500		
250M	37	55	404T	60	100	MB 70×400	Pages 5.10– 5.11	MB 70 
280S 280M	45 55	75 90	405T 444T	75 100	100 / 125 125 / 150	MB 70×550		
315S	75	110	445T	125 / 150	150 / 200	MB 70×650		
315M 315L	90 / 110 110–160	132–160 160–200	447T 449T	150–200 200–300	200–250 250–300	MB 70×800		
315M 315L	90 / 110 110–160	132–160 160–200	447T 449T	150–200 200–300	200–250 250–300	MB 100×750	Pages 5.12– 5.13	MB 100 
355S 355M 355L	132–160 200–250 200–250	200–250 250 250	586/7	250–350	300–350			

Directions regarding customized designs of motorbases on pages 5.14–5.15.
In case of possibly not mentioned motor frame sizes, please contact **ROSTA**.

Test forces for ideal belt tensioning

The ROSTA Motorbase is offering with its mechanical pretensioning device the ideal calibration of the relevant belt tension, based on the test force recommendations of the belt suppliers. These recommended test forces for the most common V-belt sizes are mentioned in the test force table on the right.

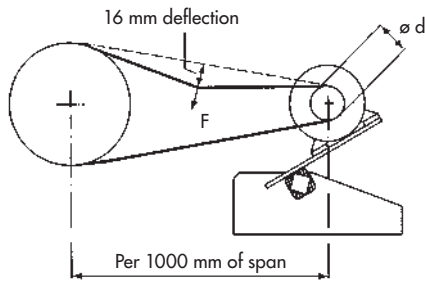

Test force table by initial V-belt installation

(standard values for the most common types of V-belts)

V-belt type	Width [mm]	Height [mm]	Diam. of smaller pulley [mm]	Initial operation test-force F_i^* [N]	Operational test-force F_o^* [N]
XPZ, SPZ	10	8	56–71	20	16
			75–90	22	18
			95–125	25	20
			≥ 125	28	22
XPA, SPA	13	10	80–100	28	22
			106–140	38	30
			150–200	45	36
			≥ 200	50	40
XPB, SPB	16	13	112–160	50	40
			170–224	62	50
			236–355	77	62
			≥ 355	81	65
XPC, SPC	22	18	224–250	87	70
			265–355	115	92
			≥ 375	144	115
Z	10	6	56–100	5–7.5	
A	13	8	80–140	10–15	
B	17	10	125–200	20–30	
C	22	12	200–400	40–60	
D	32	19	355–600	70–105	

* Test force for V-belts. By ideal belt tensioning a deflection of 16 mm per 1000 mm pulley center distance shall occur. (By shorter or longer span, the value 16 mm has to be interpolated.)

Usual positioning of the ROSTA Motorbase in screen drive applications

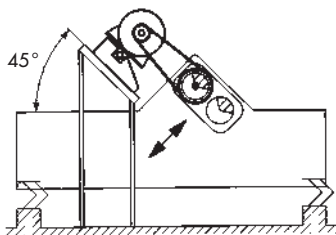

Linear Motion Screen
"Low-Head" Types

1. "Overhead" Configuration

Base plate "center mounted" on ROSTA element. Plate position horizontally on base. Installation of the entire base 45° inclined (aligned to exciter).

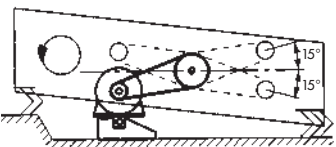

Circular Motion Screen
"Ripple-Flow" Types

2. "Along-Side" Configuration

Base plate "center mounted" on ROSTA element. Plate position horizontally on base. Motor shaft min. 15° above or below the driven eccentric shaft.



Technical drawing of a 100.5mm high bracket. The drawing shows a top view and a side view. The top view dimensions are: total width 230, mounting hole offset 60, mounting hole diameter 10, and a distance of 100.5 from the mounting hole to the top edge. The side view dimensions are: total width 220, mounting hole offset 60, mounting hole diameter 10, and a distance of 100.5 from the mounting hole to the top edge. The drawing also shows a detail of the mounting hole with a diameter of 10 and a distance of 25 from the mounting hole to the top edge. The drawing is labeled with 'A' and 'K'.

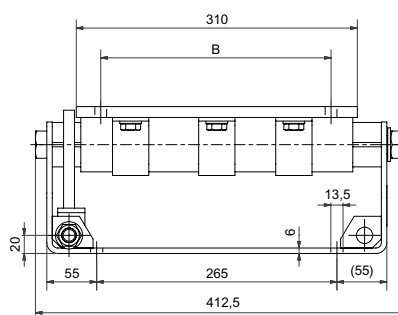
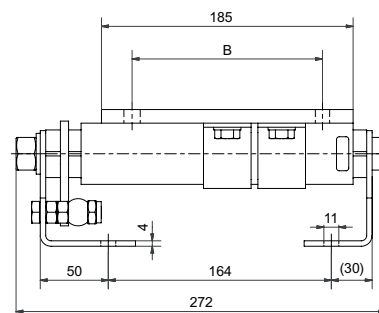

Art. No.	Type	IEC			NEMA				Weight [kg]	
		Motor Frame Size	A	B	K	Motor Frame Size	A	B		K
02 200 201	MB27 × 120	90S	140	100	10.5	143T	140	102	10.5	8
		90L	140	125	10.5	145T	140	127	10.5	
		100L	160	140	10.5	182T	190	114	10.5	
		112M	190	140	10.5	184T	190	140	10.5	
02 000 301	MB38 × 300	132S	216	140	M10	213T	216	140	M10	26
		132M	216	178	M10	215T	216	178	M10	
		160M	254	210	13	254T	254	210	13	
		160L	254	254	13	256T	254	254	13	

* Is the resulting tension-travel of the motorbase not effectual, we recommend to position the motor plate in "off-set" configuration, offering enlarged compensation travel.

- 1 Motor plate
- 2 Side supports
- 3 Pretensioning device
- 4 Rubber suspension element
with brackets
(MB 27: 2 brackets /
MB 38: 3 brackets)

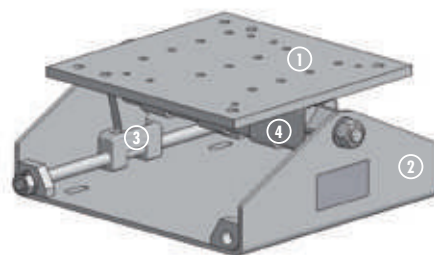
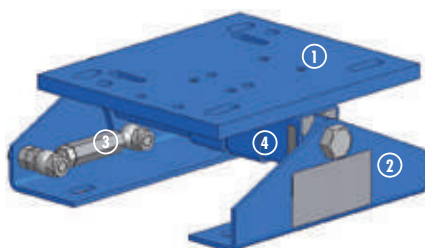

MB 38×300
Steel parts galvanized

Mounting instructions for MB 27 and MB 38

1 Ascertainment of the ideal motorbase position

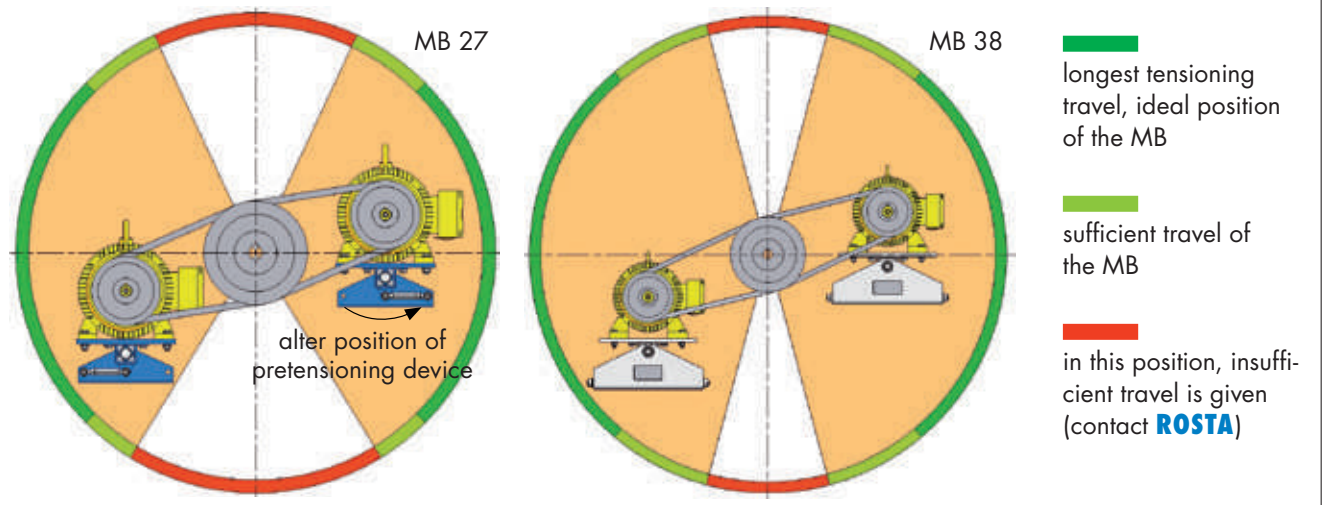

2 Support fixations

MB 27:

4 oblong holes 11 × 25 mm

MB 38:

4 oblong holes 13.5 × 35 mm

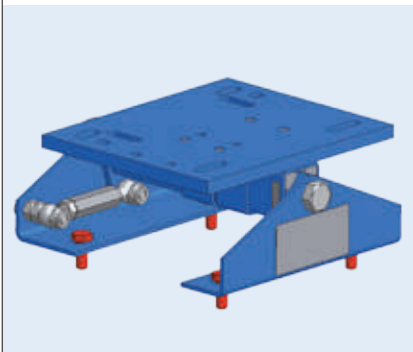

3 Alignment of pulleys and motor fixation

4 screws according relevant motor size

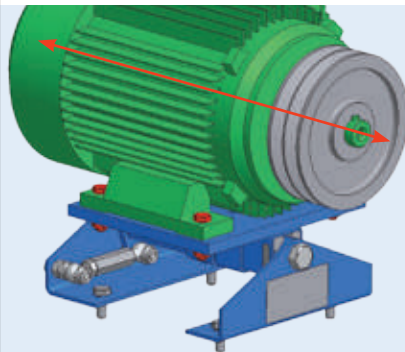

4 Loosen of the shaft screw (element axis)

MB 27: M16 and MB 38: M20

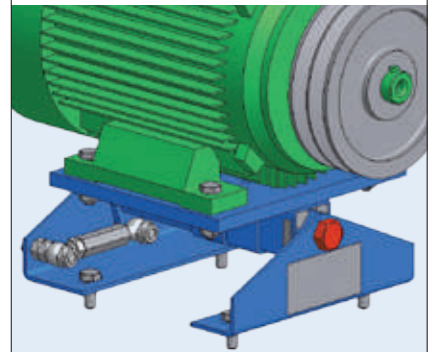

5 Insert and tension the belts, control belt test force

Tensioning of the belts according to belt suppliers recommended test force (table on page 5.5).

MB 27: by means of threaded bushing M10

MB 38: by means of threaded shaft M16 × 1.5

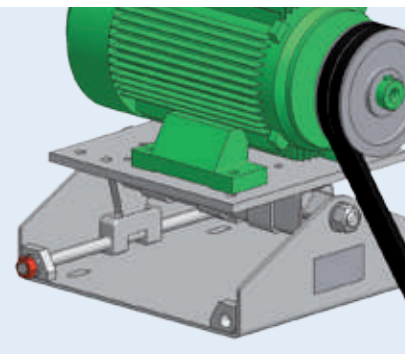
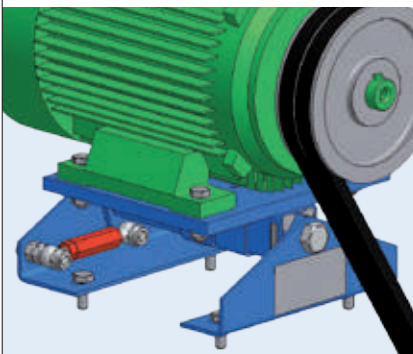

6 Tighten of the shaft screw (element axis), start of operation

MB 27: M16 (locking torque 210 Nm)

MB 38: M20 (locking torque 410 Nm)

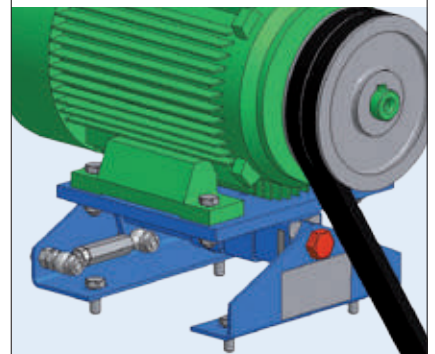

Retension:

Generally retensioning is not necessary, however, we recommend to control the belt tension after a few days of operation (after "running-in" of the belts).



Motorbases Type MB 50

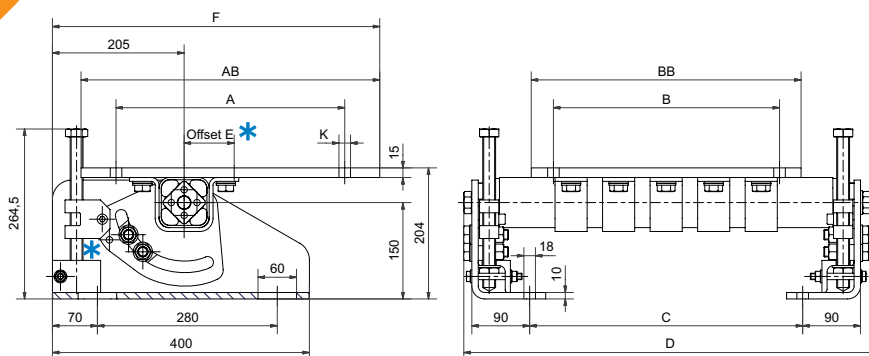

Art. No.	Type	IEC			NEMA											Weight [kg]
		Motor Frame Size	A	B	K	Motor Frame Size	A	B	K	AB	BB	C	D	E	F	
02 200 516	MB 50×270-1	160M	254	210	14	254T	254	210	14	320	315	245	463	25	437	41
		160L	254	254	14	256T	254	254	14							
02 200 507	MB 50×270-2	180M	279	241	14	284T	279	241	14	350	350	245	463	72	452	43
		180L	279	279	14	286T	279	279	14							
02 200 508	MB 50×400	200L	318	305	18	324T 326T	318 318	267 305	18 18	405	390	345	563	55	463	53
02 200 509	MB 50×500	225S	356	286	18	364T	356	286	18	465	420	425	643	72	510	60
		225M	356	311	18	365T	356	311	18							

Details regarding special designs, see pages 5.14–5.15.

* All ROSTA Motorbases MB 50 will be supplied with motor plate installed in **“off-set”** configuration. According to the final positioning of the base, the operating angle of the belts and the required tensioning travel, the motor plate can be altered in **“centered”** position on top of the element axis (recommendable by screen drive applications). Relevant threaded fixation holes are existent in plate.

- 1 Motor plate
- 2 Side supports
- 3 Pretensioning device
(MB 50×270-1 and MB 50×270-2: 1 device / MB 50×400 and MB 50×500: 2 devices)
- 4 Rubber suspension element with axial-guide bearings and brackets (depending on size = 3–5 brackets)

For possibly required additional tensioning travel of the motor plate, the adjusting block of the pretensioning device can be set in the second hole-position of the friction plate (3).

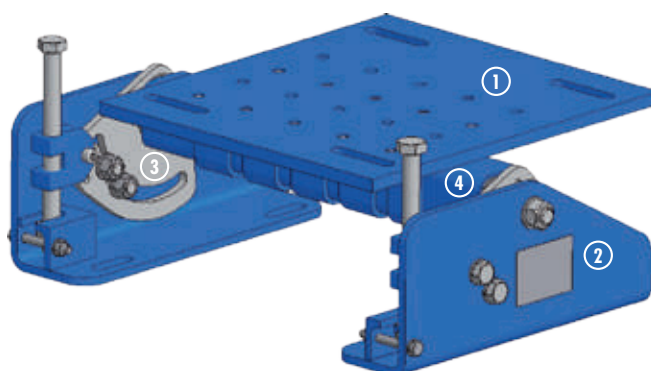

Mounting instructions for MB 50

1 Ascertainment of the ideal motorbase position

Operation area "above"

Motor plate standing ~ 30° inclined

Operation area "below"

Motor plate standing ~ horizontal

- longest tensioning travel, ideal position of the MB
- sufficient travel of the MB
- in this position, insufficient travel is given (contact **ROSTA**)

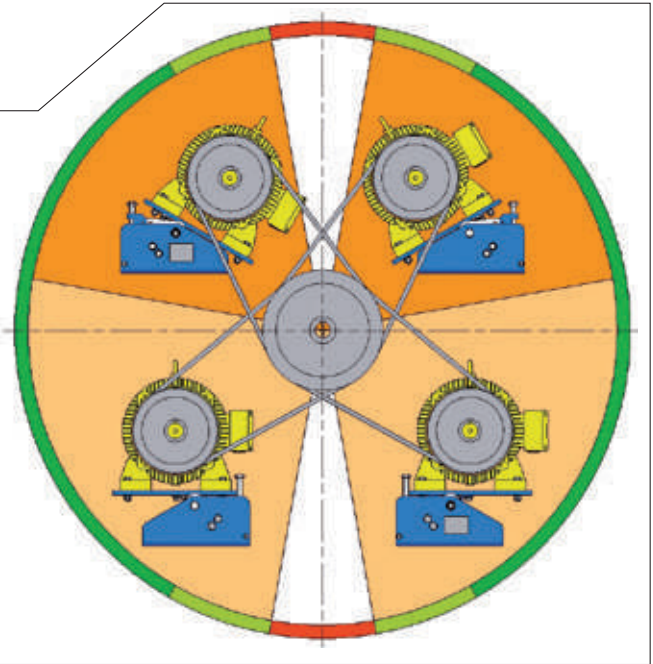

2 Support fixations

4 oblong holes 18x60 mm

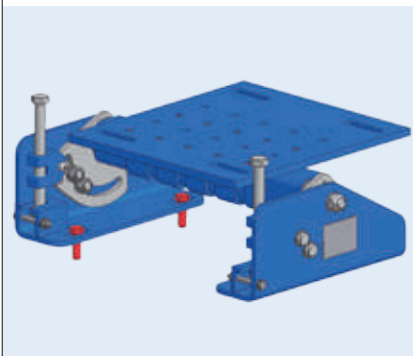

3 Alignment of pulleys and motor fixation

4 screws according relevant motor size

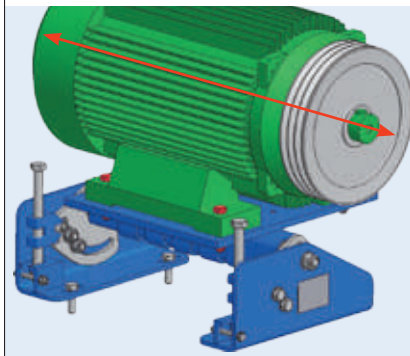

4 Loosen of the shaft screw (element axis) and of the screws on friction plate(s)

M20 and M16

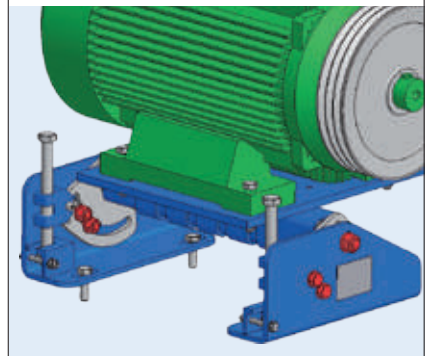

5 Insert and tension the belts, control belt test force

Tensioning of the belts according to belt suppliers recommended test force (table on page 5.5).

Operation area "below":

adjust with M20x1.5 screw
(for tightening = screw block upwards)

Operation area "above":

adjust with M20x1.5 screw
(for tightening = screw block downwards)

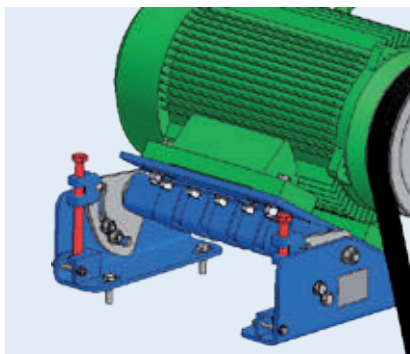
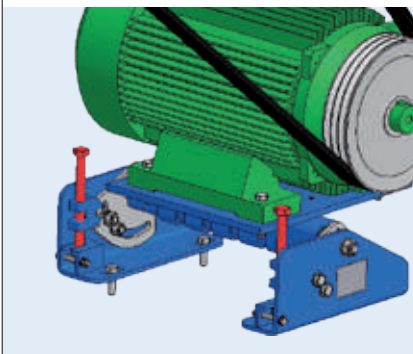

6 Tighten of the shaft and fixing screws on friction plate(s), start of operation

M20 (locking torque 410 Nm),
M16 (locking torque 210 Nm)

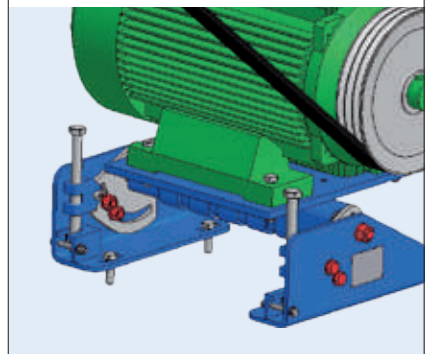

Retension:

Generally retensioning is not necessary, however, we recommend to control the belt tension after a few days of operation (after "running-in" of the belts).



Motorbases Type MB 70

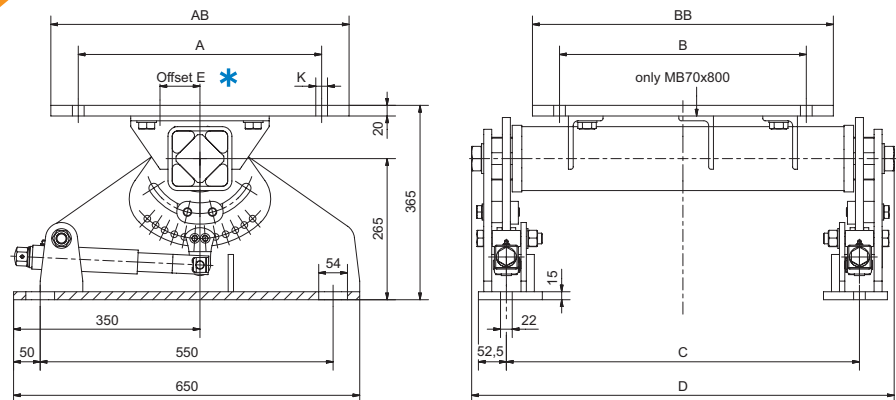

Art. No.	Type	IEC				NEMA									Weight [kg]
		Motor Frame Size	A	B	K	Motor Frame Size	A	B	K	AB	BB	C	D	E	
02 200 710	MB 70×400	250M	406	349	22	404T	406	311	22	510	410	513	643	50	142
02 200 711	MB 70×550	280S	457	368	22	405T	406	349	22	560	565	663	793	50	169
		280M	457	419	22	444T	457	368	22						
02 200 712	MB 70×650	315S	508	406	26	445T	457	419	22	630	660	763	893	70	191
02 200 713	MB 70×800	315M	508	457	28	447T	457	508	22	630	805	913	1043	70	216
		315L	508	508	28	449T	457	635	22						

Details regarding special designs, see pages 5.14–5.15.

* All ROSTA Motorbases MB 70 will be supplied with motor plate installed in **“centered”** configuration on top of the element axis. According to the final positioning of the base, the operating angle of the belts and the required tensioning travel, the motor plate can be altered in **“off-set”** position. Relevant threaded fixation holes are existent in plate.

For possibly required additional tensioning travel of the motor plate, the fork head of the pretensioning device can be set in one of the eleven hole positions of the friction plate (3).

- 1 Motor plate
- 2 Side supports
- 3 Pretensioning devices = 2 devices
- 4 Rubber suspension element with axial guide bearings

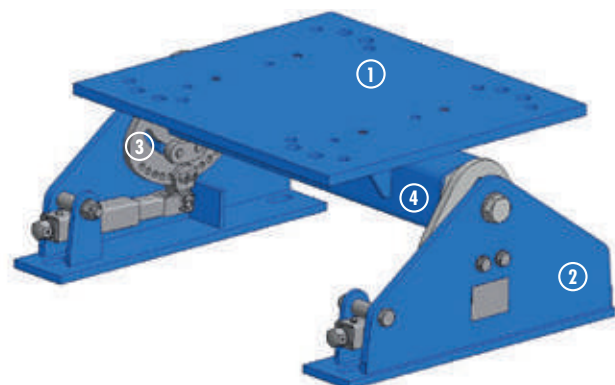

Mounting instructions for MB 70

1 Ascertainment of the ideal motorbase position

- longest tensioning travel, ideal position of the MB
- sufficient travel of the MB
- in this position, insufficient travel is given (contact **ROSTA**)

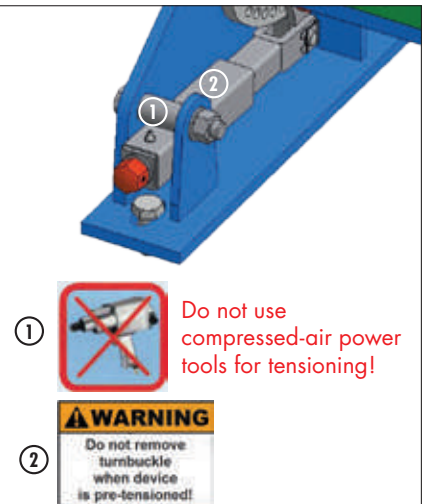
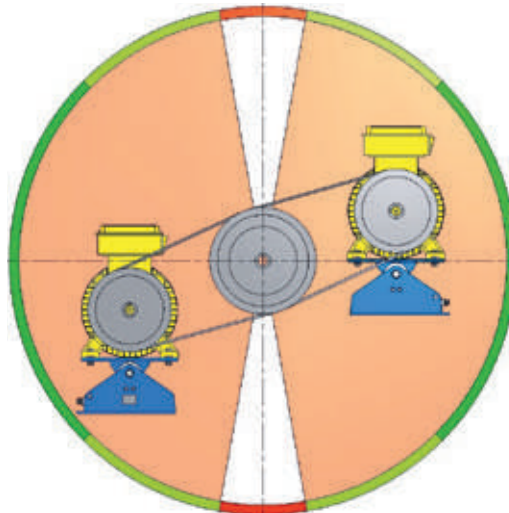

2 Support fixations

4 oblong holes 22x54 mm

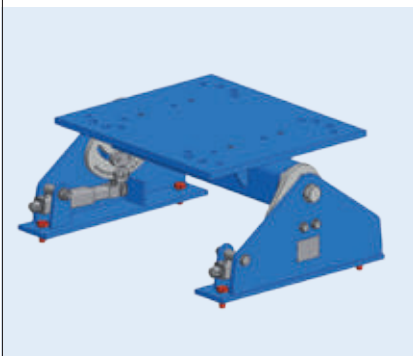

3 Alignment of pulleys and motor fixation

4 screws according relevant motor size

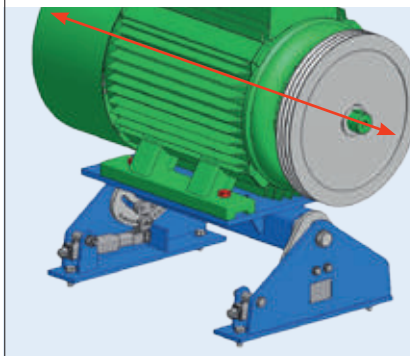

4 Loosen of the center screws (element axis) and of the screws on friction plates

M30 and M16

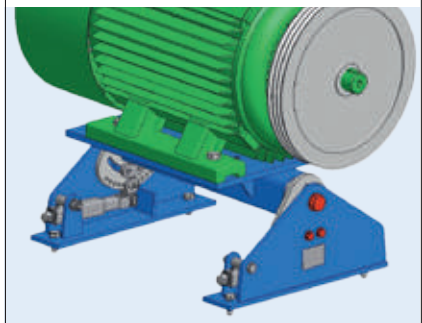

5 Insert and tension the belts, control belt test force

Tensioning of the belts according to belt suppliers recommended test force (table on page 5.5).

Adjust tension with screws M20

Readjustment of the pretensioning device to required tension travel

1. Tighten center screws and screws on friction plates
2. Loosen M12 hex-screws of fork head, select new position, assure new position of fork head again
3. Loosen the shaft and fixing screws again
4. Continue the tensioning with screws M20

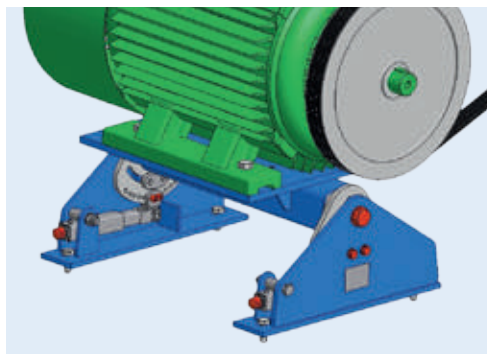
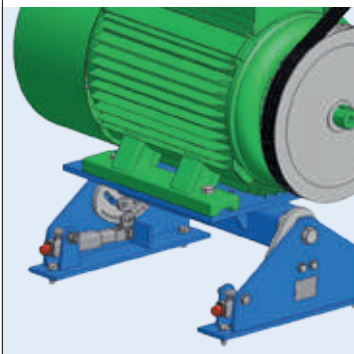

6 Tighten of the center and fixing screws (friction plates), start of operation

M30 (locking torque 1400 Nm),
M16 (locking torque 210 Nm)

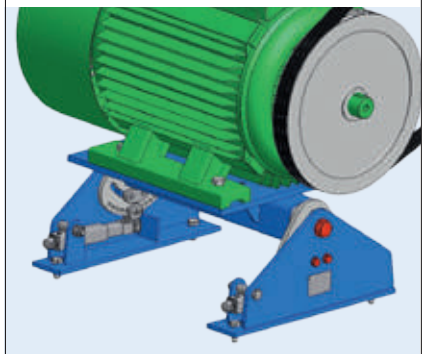

Retension:

Generally retensioning is not necessary, however, we recommend to control the belt tension after a few days of operation (after "running-in" of the belts).

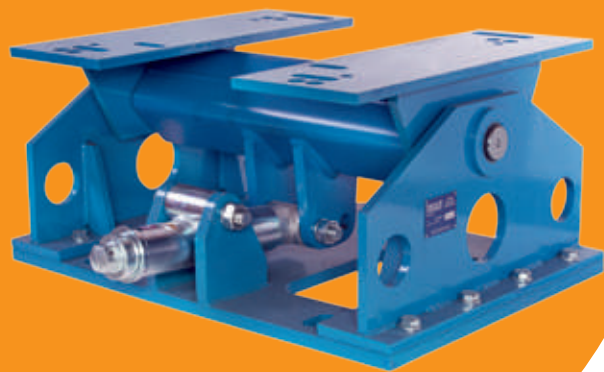

Motorbases Type MB 100

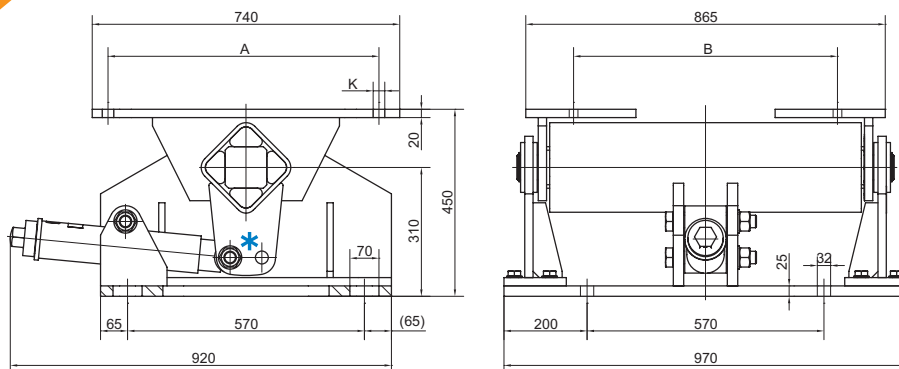

Art. No.	Type	IEC				NEMA				Weight [kg]
		Motor Frame Size	A	B	K	Motor Frame Size	A	B	K	
02 200 900	MB 100×750	315M	508	457	28	447T	457	508	21	490
		315L	508	508	28	449T	457	635	21	
		355S	610	500	28	586/7	584	560	30	
		355M	610	560	28					
		355L	610	630	28					

Details regarding special designs, see pages 5.14–5.15.

* For possibly required longer tensioning travel of the motor L-supports, the pretensioning device (3) shall be bolted into the front holes of the fork-head on the rubber suspension element.

- 1 Motor L-supports
- 2 Side supports
- 3 Pretensioning device
- 4 Rubber suspension element

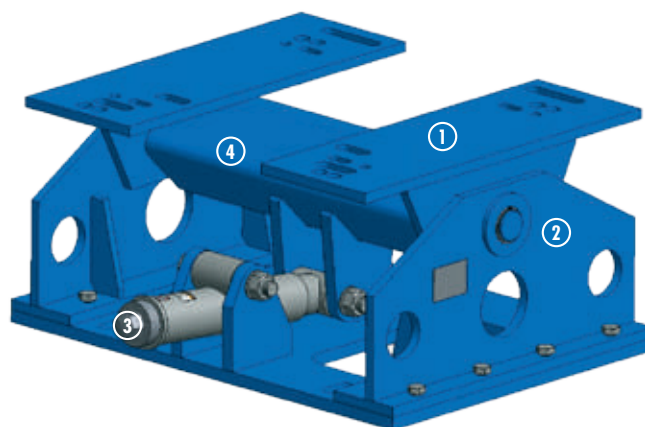

Mounting instructions for MB 100

1 Ascertainment of the ideal motorbase position

- longest tensioning travel, ideal position of the MB
- sufficient travel of the MB
- in this position, insufficient travel is given (contact **ROSTA**)

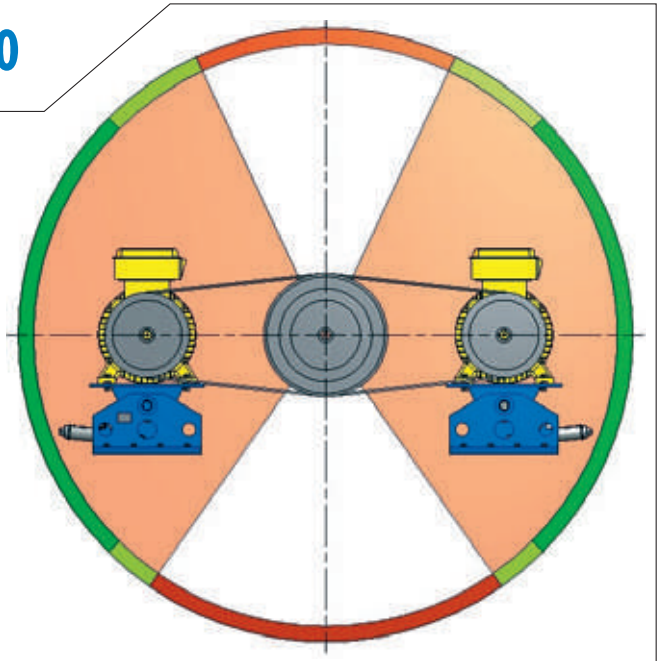

2 Support fixation

4 oblong holes 32×70 mm

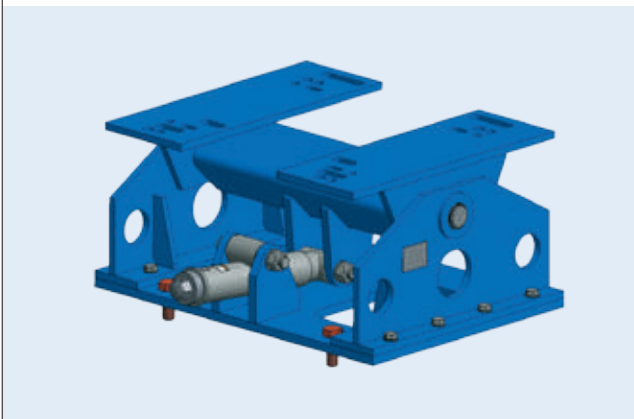

3 Alignment of pulleys and motor fixation

4 screws according relevant motor size

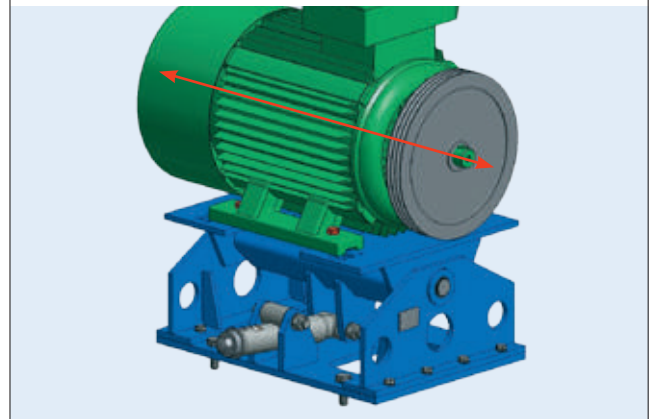

4 Insert and tension the belts, control belt test force

Tensioning of the belts according to belt suppliers recommended test force (table on page 5.5).

Adjust tension with 46 mm hook wrench

①



Do not use
compressed-air power
tools for tensioning!

②



Do not remove
turnbuckle
when device
is pre-tensioned!

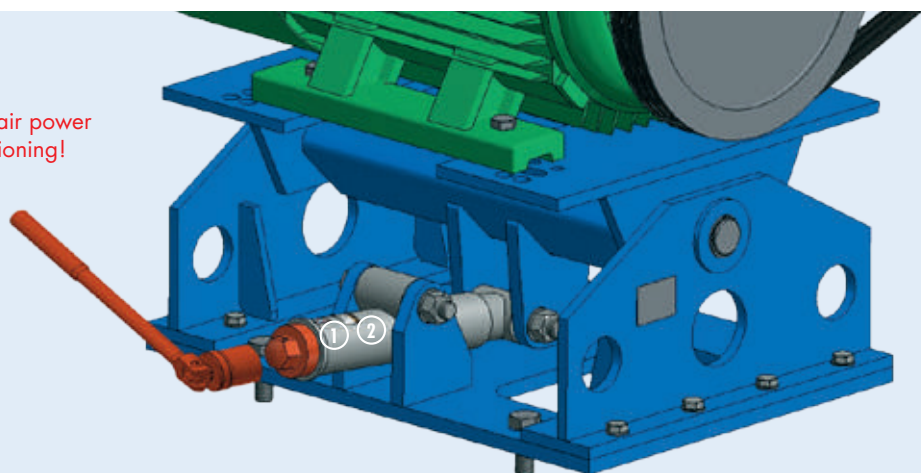

Retension:

Generally retensioning is not necessary, however, we recommend to control the belt tension after a few days of operation (after "running-in" of the belts).

ROSTA Motorbases in customized design for special applications

Fan drive in heat exchanger with vertically installed motor on MB 50, special

The MB 50 had been equipped with an additional bronze glide bearing to assure the axial position of the motor on the elastic ROSTA element.

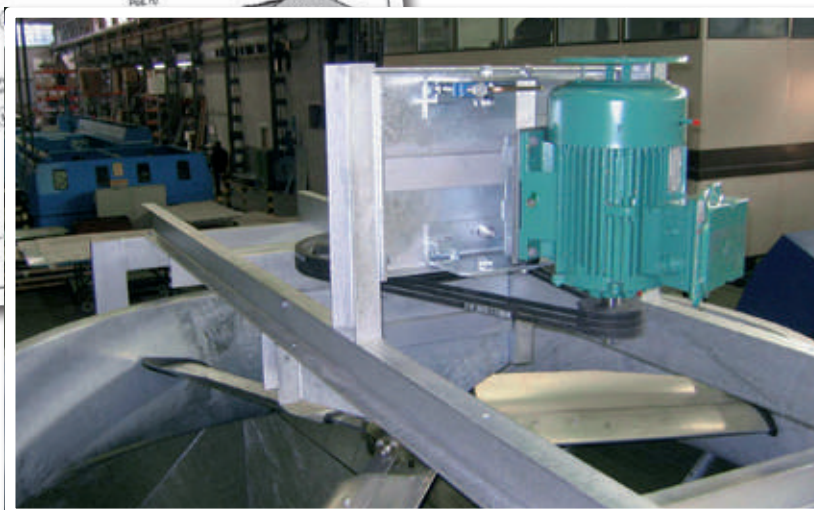
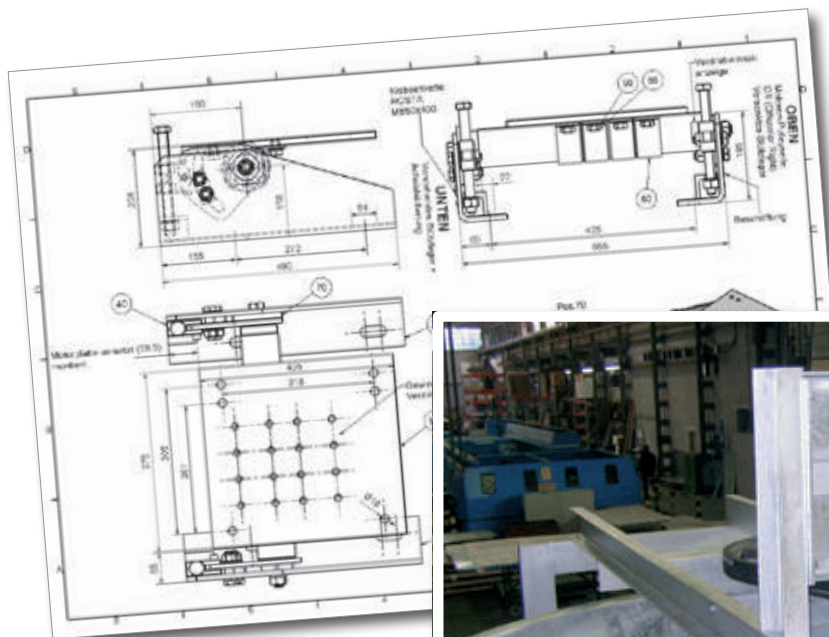

Installation of cooling compressors in busses on MB 45 special, equipped with heat-resistant elastic inserts Rubmix 40

In this specific application, the ROSTA Motorbase is fulfilling two main functions: keeps the belt tightened between Diesel-engine and cooling compressor, does prevent the transmission of compressor vibrations into the bus chassis.

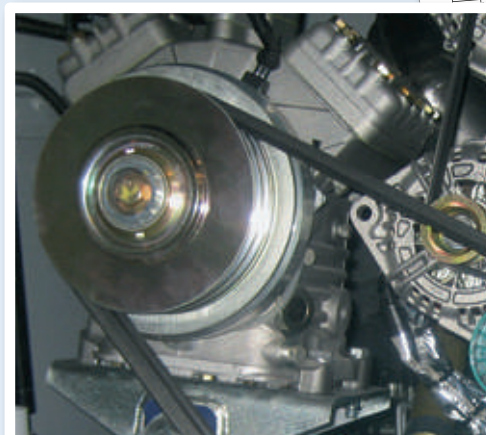
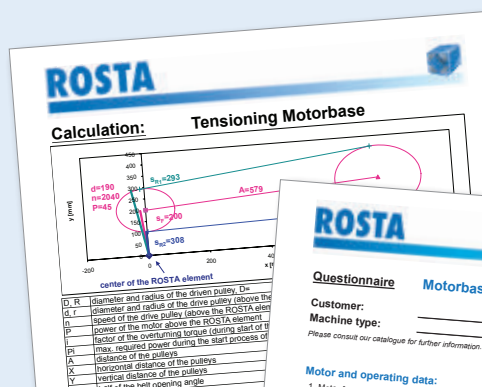

ROSTA

Questionnaire Motorbases for friction belt-drives

Customer: _____ Date: _____

Machine type: _____

Please consult our catalogue for further information.

Motor and operating data:

- Motor frame size _____
- Motor power _____ kW
- Motor speed _____ min⁻¹
- Motor weight _____ kg
- Daily operating time _____ hrs.
- Run-up control ☐ no ☐ yes, power of consumption _____ kW

Dimensions and configuration:

- drive pulley _____ mm
- driven pulley _____ mm
- Center distance pulleys _____ mm
- Center positioning or Off-set positioning ☐ Off-set positioning
- Special positionings:
 - ☐ Wall mounting, element horizontal
 - ☐ Wall mounting, element vertical
 - ☐ overhead, ceiling installation
- Please send us the positioning configuration and the direction of rotation (drawing 3D, 2D or sketch)
- Please send us the data sheet of the belt selection from the belt supplier
- Further notices (temperature, chemical influences etc.): _____

Our proposal is based on the received information and technical data from you. Other, unknown factors may influence the proper function of our products. In this case our proposal has to be revised.

ROSTA AG, CH - 5602 Hunzenschwil

Tel.: +41 (0)62 897 24 21, Fax: +41 (0)62 897 15 10, E-mail: info@rosta.ch, Internet: www.rosta.com



www.rosta.com

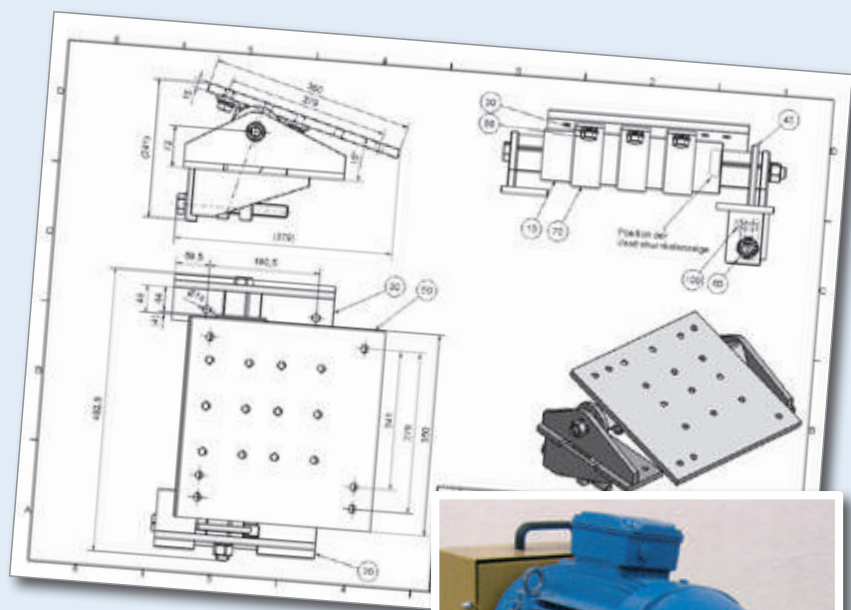

Drive motor of slurry-pump (centrifugal pump) installed on MB 50×270 special

The ROSTA Motorbase is assuring the continuous and slippage-free transmission of the required drive torque to maintain the high column of slurry material in mining fluid-transport systems.



Heavy-Duty belt and chain tensioners made out of Motorbase components

The ROSTA Motorbase elements are offering extremely high torques to tension heaviest chains and oversized belt drives.

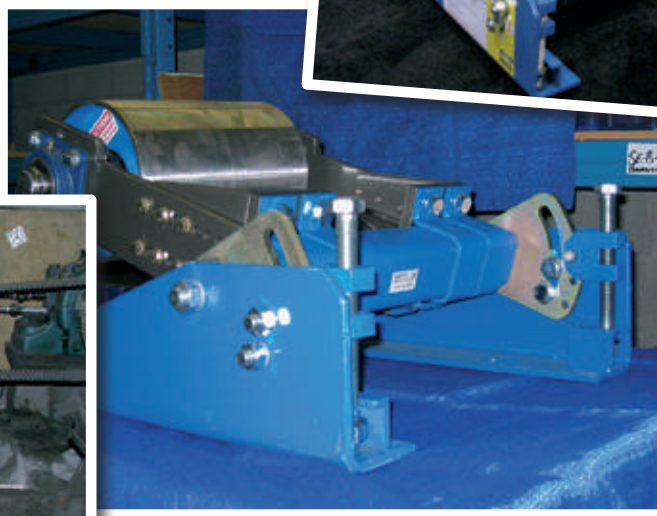

Unlimited possibilities!

A few examples:



ROSTA 
swinging solutions

ROSTA AG
CH-5502 Hunzenschwil
Phone +41 62 897 24 21
Fax +41 62 897 15 10
E-Mail info@rosta.ch
Internet www.rosta.com

Changes regarding contents reserved.
Any reprint, also in extracts, requires our explicit and confirmed approval.